

# DOOR SENSOR INSTALLATION

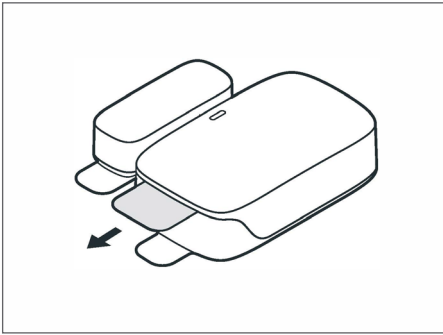

Step 1 - Pull the battery tab to activate the sensor.

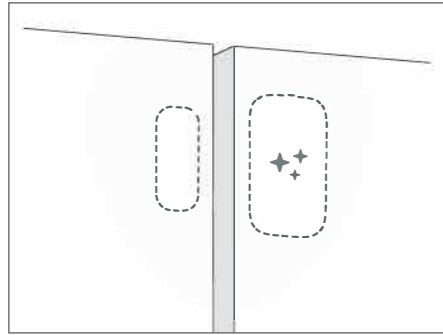

Step 2 - Make sure the mounting surfaces are clean and dry.

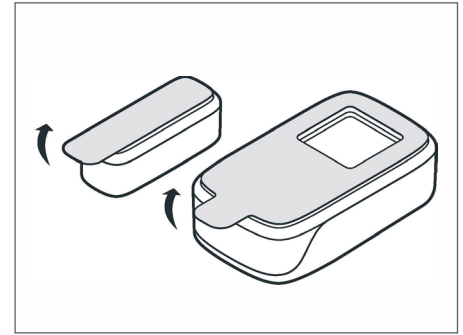

Step 3 - Remove the adhesive backing from both the sensor and magnet.

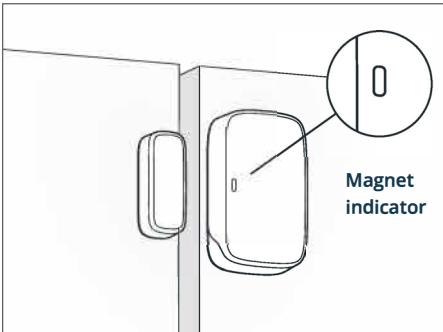

Step 4 - Place the magnet on the same side as the indicator mark. They should be center aligned.

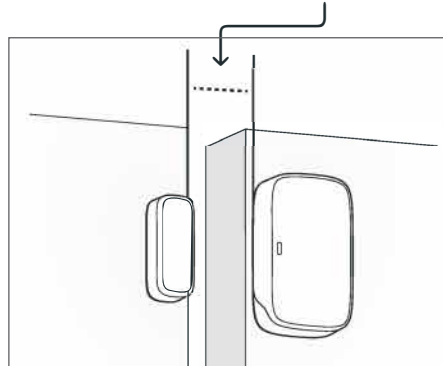

Step 5 - Ensure gap is less than 30mm (1.2 inches).

**Note: Installing on magnetic surfaces can reduce the required gap to 15mm (0.6 inches).**

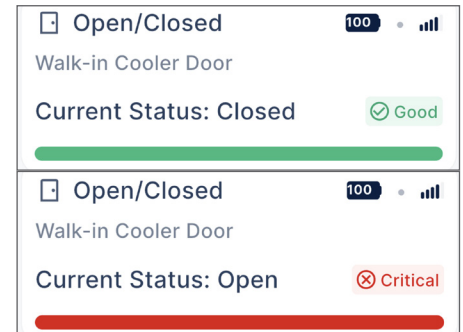

Step 6 - Test the sensor's performance. In the REM module, select the equipment where the sensor has been added to view it's status. Close the door/window and confirm in the app, then open the door/window and wait 5-10 seconds and pull-down to refresh the app to ensure that it indicates open.

**Note: The status indicators in this example are green for closed and red for open. Those colors will be reversed if your template is set to alert when the door/window was left closed.**